

CASTORS



Light Duty

Ideal Castors for day to day applications in homes, offices, supermarkets, malls etc.



Medium Duty

Castors ideally suited for hospitals, offices, malls, warehoused etc.



Heavy Duty

Castors for Tough loads & rough surfaces. Ideal for factories, warehouses, aviation industries. Etc.



Super Heavy Duty

For ultra heavy material handling, one can rely on these Super heavy duty castors. Best for use in Automobile Industries, aviation, large factories, mills etc.



Wheels

A massive variety of Wheels ranging from 1" TO 21", for loads upto 10 tonnes.

TROLLIES



Medium

Folding platform trollies for easy transportations & loads upto 350 kgs.



Heavy

Engineered to perfection, Rexello platform trollies can carry loads upto 1 ton effortlessly.



General

For hassle-free material handling, a wide range of wheelbarrows, gas cylinder trollies, sack trucks etc.



Other Products

Wide range of material handling products for domestic use, as well as industrial applications.

GUIDE

CHOOSING THE RIGHT CASTOR AND WHEEL

To do its job properly, a castor must roll and swivel easily. It can only do this if the trolley and the castor are properly matched and the castor is properly fitted.

SELECT THE FORK BY CONSIDERING :

Swivel or rigid fitting – how it will be fitted to the trolley.

If appropriate – choose the attachment required (if available)

Springs – take impact strain off trolley, protect loads, provide greater comfort.

Swivel and wheel lock – make trolley rigid and stable.

Directional lock – make trolley rigid and stable.

Directional lock – allows for good tracking when locked and maximum maneuverability in confined spaces when unlocked.

FITTING :

If fixed and swivel castors are to be used together, have the fixed castors at the front, the trolley turns more easily. Never try to get the unevenness out of a warped trolley by half inserting fittings. You can get up to 8 mm of adjustment with washers, but do not let it float. Tighten tubular fittings firmly, but do not over-tighten.

SELECT THE WHEEL BY CONSIDERING

Load – the larger the dia the greater the load that can be carried. Rough surfaces or high impact loads halve the capacity. Roller bearings permit higher wheel loads for hand pushing due to lower friction.

Surface – the larger a wheel the easier it rolls on all surfaces. On smooth surfaces hard treads roll easier, but consider potential floor damage. On rough or soft surfaces soft treads roll easiest.

Environment – wet or corrosive – specify type of chemicals.

Threads, lint or fluff – specify thread guards.

Heat or vacuum – use phenorex, reinforced nylon or cast iron. Safety temperature so that special grease can be used.

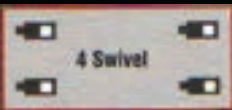
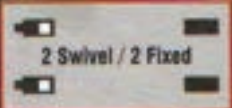
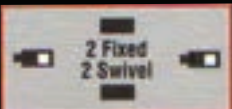
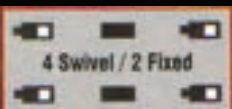
DIRECTION OF TRAVEL	MANOEUVRABILITY	STABILITY	STEERING	COMMENTS
	Maximum. Can be moved at right angles	Good except on narrow trolley	Erratic. if moved quickly over uneven surfaces	Most popular for confined spaces.
	Good except in confined spaces	Very stable. Can negotiate ramps easily	Accurate. push with rigid castors leading if heavy loads or uneven surfaces.	More open spaces or long runs.
	Very good, but cannot negotiate ramps	Fair. except if heavy loads placed on corners	Accurate.	Rigid castors usually next size larger, so will rock on two centre wheels carrying load.
	High, Can be turned in own length but not moved at right angles	Most stable	Best for long wheelbases and straight lines	Centre castors can be equal or unequal in height to end castors.

CASTOR SELECTION



5 TO 65

LIGHT DUTY

25MM - 100MM

Plates

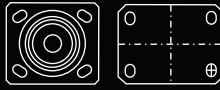

Top Fixture Options

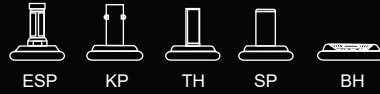

Brake Option



Product Application

Suitable for use on all domestic office & hospital equipments



40 TO 820

MEDIUM DUTY

63MM - 200MM

Product Application

Suitable for use on all domestic office & hospital equipments



STAINLESS STEEL SS304 CASTORS AVAILABLE IN SERIES

• DXM4/SS • GRVD/SS • HSC/SS • HSC/TW/SS • RG/SS • RPS/SS • SSR(MRN)

CASTOR SELECTION



200 TO 1800

HEAVY DUTY

100MM - 400MM

Product Application

Suitable for use on all industrial application & in warehouse & aviation industry etc.

Plates

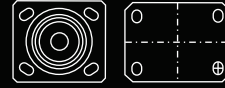

Brake Option



500 TO 10,000

SUPER HEAVY DUTY

150MM - 525MM

Product Application

Ideal for very heavy loads in factories, warehouses & Automobile industries.



SPRING LOADED OPTIONS FOR SHOCK ABSORPTION AVAILABLE IN SERIES



CASTOR SERIES



RD 1 SERIES

Light Duty Loads **15-35 KGS.**

Suitable for use on all light domestic, office & hospital equipments

Plates

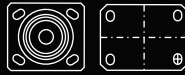

Top Fixture Options

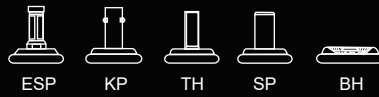

Brake Option



Refer page 15-30 for different wheel materials



Wheel Size

38mm x 20mm

50mm x 22mm

RD 2 SERIES

Light Duty Loads **40-65 KGS.**

Suitable for use on all light domestic, office & hospital equipments

Plates

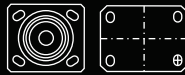

Top Fixture Options



Brake Option



Refer page 15-30 for different wheel materials



Wheel Size

50mm x 22mm

63mm x 22mm

75mm x 22mm

100mm x 22mm

RD 3 SERIES

Light Duty Loads **45-100 KGS.**

Suitable for light duty Industrial & Hospital equipments.

Plates

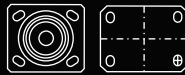

Top Fixture Options

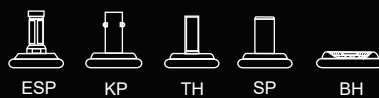

Brake Option



Refer page 15-30 for different wheel materials



Wheel Size

63mm x 28mm

75mm x 28mm

100mm x 28mm

125mm x 28mm

RD 4 SERIES

Medium Duty Loads **145-210 KGS.**

Suitable for medium duty Industrial trolleys & canteen

Plates



Top Fixture Options

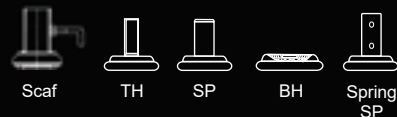

Brake Option



Refer page 15-30 for different wheel materials



Wheel Size

75mm x 38mm

100mm x 38mm

125mm x 38mm

CASTOR SERIES

RD 5 SERIES

Medium Duty Loads **250-820 KGS.**

Suitable for medium duty Industrial, Warehousing & Commercial Application equipments.

Plates

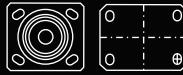

Top Fixture Options

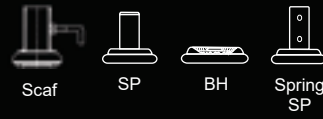

Brake Option



Refer page 15-30 for different wheel materials

 **Wheel Size**

150mm x 50mm

200mm x 50mm

DLF SERIES

Light Duty Loads Up to **25 KGS.**

Suitable for use on all light domestic, office & hospital equipments

Plates



Top Fixture Options

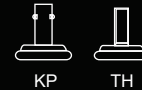

 **Wheel Size**

50mm



Refer page 15-30 for different wheel materials

DN SERIES

Light Duty Loads **20-50 KGS.**

Suitable for light duty Industrial & Hospital equipments.

Plates

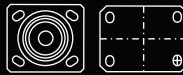

Top Fixture Options



Brake Option



 **Wheel Size**

50mm x 22mm

63mm x 22mm

75mm x 22mm



Refer page 15-30 for different wheel materials

DN/TW SERIES

Light Duty Loads **20-50 KGS.**

Suitable for light duty Industrial trolleys & canteen equipments.

Plates



Brake Option



 **Wheel Size**

50mm x 22mm

63mm x 22mm

75mm x 22mm



Refer page 15-30 for different wheel materials

AA/F SERIES

Medium Duty Loads **5-30 KGS.**

Suitable for medium duty Industrial, Warehousing & Commercial Application equipments.



Refer page 15-30 for different wheel materials

Plates



 **Wheel Size**

25mm x 12mm

31mm x 15mm

38mm x 20mm

50mm x 22mm

BRVD SERIES

Light Duty Loads **20-35 KGS.**

Suitable for use on all light domestic, office & hospital equipments



Refer page 15-30 for different wheel materials

Plates

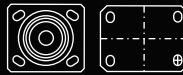

Top Fixture Options

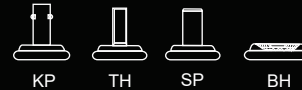

Brake Option



 **Wheel Size**

50mm x 22mm

75mm x 22mm

100mm x 22mm

125mm x 22mm

FR SERIES

Light Duty Loads Upto **5-40 KGS.**

Suitable for light duty Industrial & Hospital equipments.



Refer page 15-30 for different wheel materials

Plates

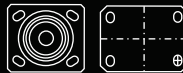

Top Fixture Options

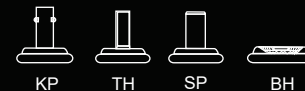

Brake Option



 **Wheel Sizes**

25mm x 12mm

31mm x 15mm

38mm x 20mm

50mm x 22mm

63mm x 22mm

75mm x 22mm

100mm x 22mm

100mm x 31mm

FRVD SERIES

Light Duty Loads Upto **5-40 KGS.**

Suitable for light duty Industrial trolleys & canteen equipments.



Refer page 15-30 for different wheel materials

Plates



Top Fixture Options

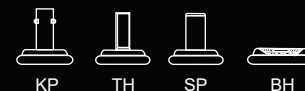

Brake Option



 **Wheel Sizes**

38mm x 20mm

50mm x 22mm

63mm x 22mm

75mm x 22mm

100mm x 22mm

CASTOR SERIES

GRVD SERIES

Light Duty Loads Upto **20-50 KGS.**

Suitable for light duty Industrial, Warehousing & Commercial Application equipments.



Refer page 15-30 for different wheel materials

Plates

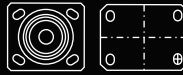

Top Fixture Options



Brake Option



 **Wheel Size**

50mm x 20mm

63mm x 22mm

75mm x 22mm

100mm x 22mm

RR SERIES

Light Duty Loads **15-25 KGS.**

Suitable for use on all light domestic, office & hospital equipments



Refer page 15-30 for different wheel materials

Plates

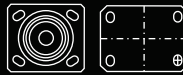

Top Fixture Options

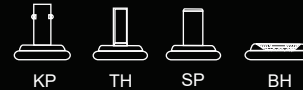

Brake Option



 **Spherical Wheel Size**

38mm

50mm

63mm

AAJN SERIES

Medium Duty Loads Upto **50 KGS.**

Suitable for medium duty Industrial & Hospital equipments.



Refer page 15-30 for different wheel materials

Plates

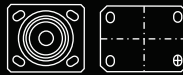

Top Fixture Options



Brake Option



 **Wheel Size**

150mm x 25mm

200mm x 31mm

DX SERIES

Medium Duty Loads **65-250 KGS.**

Suitable for medium duty Industrial trolleys & canteen equipments.



Refer page 15-30 for different wheel materials

Plates

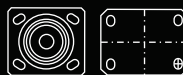

Top Fixture Options

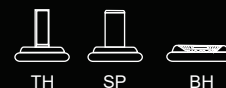

Brake Option



 **Wheel Size**

63mm x 38mm

125mm x 38mm

75mm x 38mm

150mm x 38mm

100mm x 38mm

160mm x 38mm

CASTOR SERIES

DXM2 SERIES

Medium Duty Loads **150-210 KGS.**

Suitable for medium duty Industrial, Warehousing & Commercial Application equipments.



Refer page 15-30 for different wheel materials

Plates



Brake Option



Wheel Size

75mm x 50mm

100mm x 50mm

125mm x 50mm

DXM4 SERIES

Medium Duty Loads **60-140 KGS.**

Suitable for use on all medium domestic, office & hospital equipments



Refer page 15-30 for different wheel materials

Plates

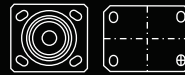

Top Fixture Options

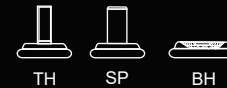

Brake Option



Wheel Size

75mm x 31mm

100mm x 31mm

125mm x 31mm

150mm x 31mm

DXMS SERIES

Heavy Duty Loads **180-700 KGS.**

Suitable for medium duty Industrial & Hospital equipments.



Refer page 15-30 for different wheel materials

Plates



Wheel Sizes

80mm x 40mm

100mm x 40mm

125mm x 40mm

MRN SERIES

Medium Duty Loads **100-500 KGS.**

Suitable for medium duty Industrial trolleys & canteen equipments.



Refer page 15-30 for different wheel materials

Plates



Top Fixture Options



Brake Option



Wheel Size

100mm x 50mm

125mm x 50mm

150mm x 50mm

200mm x 50mm

CASTOR SERIES

RG SERIES

Medium/Heavy Duty Loads **65-350 KGS.**

Suitable for medium duty Industrial, Warehousing & Commercial Application equipments.



Refer page 15-30 for different wheel materials

Plates

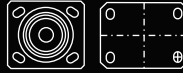

75mm x 31mm
100mm x 31mm
125mm x 38mm
150mm x 50mm

Top Fixture Options

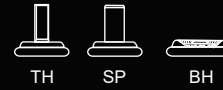

Brake Option



 **Wheel Sizes**

160mm x 40mm	250mm x 60mm
180mm x 45mm	280mm x 50mm
200mm x 50mm	280mm x 63mm
250mm x 50mm	300mm x 50mm

RG50 SERIES

Medium Duty Loads **100-250 KGS.**

Suitable for use on all medium domestic, office & hospital equipments



Refer page 15-30 for different wheel materials

Plates

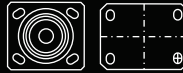

Top Fixture Options



Brake Option



 **Wheel Size**

100mm x 50mm
125mm x 50mm
150mm x 50mm
200mm x 50mm

RPS SERIES

Medium Duty Loads **100-250 KGS.**

Suitable for medium duty Industrial & Hospital equipments.



Refer page 15-30 for different wheel materials

Plates



Brake Option



 **Wheel Sizes**

125mm x 38mm
130mm x 40mm
150mm x 38mm
200mm x 50mm

AR SERIES

Heavy Duty Loads **500-3000 KGS.**

Suitable for heavy duty Industrial trolleys & canteen equipments.



Refer page 15-30 for different wheel materials

Plates



Brake Option



 **Wheel Sizes**

150mm x 50mm	250mm x 50mm	300mm x 75mm	400mm x 100mm
150mm x 75mm	250mm x 75mm	300mm x 100mm	525mm x 150mm
200mm x 50mm	250mm x 100mm	350mm x 75mm	
200mm x 75mm	300mm x 50mm	400mm x 75mm	

AR/TW SERIES

Heavy Duty Loads 500-5000 KGS.

Suitable for heavy duty Industrial, Warehousing & Commercial Application equipments.



Refer page 15-30 for different wheel materials

Plates

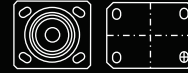

Brake Option



Wheel Sizes

150mm x 50mm	250mm x 50mm
150mm x 75mm	250mm x 75mm
200mm x 50mm	300mm x 50mm
200mm x 75mm	300mm x 75mm

HSC SERIES

Heavy Duty Loads 225-1350 KGS.

Suitable for use on all heavy domestic, office & hospital equipments



Refer page 15-30 for different wheel materials

Plates



Brake Option



Wheel Sizes

100mm x 50mm	250mm x 50mm	250mm x 75mm
125mm x 50mm	300mm x 50mm	300mm x 75mm
150mm x 50mm	150mm x 75mm	
200mm x 50mm	200mm x 75mm	

HSC/TW SERIES

Heavy Duty Loads 320-1800 KGS.

Suitable for heavy duty Industrial & Hospital equipments.



Refer page 15-30 for different wheel materials

Plates



Brake Option



Wheel Sizes

100mm x 50mm	300mm x 50mm
125mm x 50mm	
150mm x 50mm	
200mm x 50mm	

RJK2 SERIES

Heavy Duty Loads 325-800 KGS.

Suitable for heavy duty Industrial trolleys & canteen equipments.



Refer page 15-30 for different wheel materials

Plates



Brake Option



Wheel Sizes

150mm x 50mm
200mm x 50mm
250mm x 50mm
300mm x 50mm

RJK2/TW SERIES

Heavy Duty Loads **1500 KGS.**

Suitable for super heavy duty Industrial, Warehousing & Commercial Application equipments.



Refer page 15-30 for different wheel materials

Plates



Wheel Size

250mm x 50mm

RVH SERIES

Heavy Duty Loads **350-1500 KGS.**

Suitable for use on all heavy domestic, office & hospital equipments



Refer page 15-30 for different wheel materials

Plates



Brake Option



Wheel Sizes

150mm x 50mm

150mm x 75mm

200mm x 50mm

200mm x 75mm

250mm x 50mm

250mm x 75mm

300mm x 50mm

300mm x 75mm

SCS2 SERIES

Heavy Duty Loads **500-600 KGS.**

Suitable for heavy duty Industrial & Hospital equipments.



Refer page 15-30 for different wheel materials

Top Fixture Options

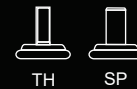

Brake Option



Wheel Sizes

150mm x 50mm

200mm x 50mm

RLT SERIES

Super Heavy Duty Loads **500-5000 KGS.**

Suitable for heavy duty Industrial trolleys & canteen equipments.



Refer page 15-30 for different wheel materials

Plates



Brake Option



Wheel Sizes

150mm x 75mm

250mm x 100mm

200mm x 75mm

300mm x 75mm

200mm x 88mm

300mm x 100mm

200mm x 100mm

400mm x 100mm

250mm x 75mm

300mm x 125mm

RLT/TW SERIES

Super Heavy Duty Loads **1000-8500 KGS.**

Suitable for super heavy duty Industrial, Warehousing & Commercial Application equipments.



Refer page 15-30 for different wheel materials

Plates



Wheel Sizes

150mm x 75mm	250mm x 100mm
200mm x 75mm	300mm x 75mm
200mm x 88mm	300mm x 100mm
200mm x 100mm	300mm x 120mm
250mm x 75mm	400mm x 100mm

ARL SERIES

Super Heavy Duty Loads **500-5000 KGS.**

Suitable for use on all heavy domestic, office & hospital equipments



Refer page 15-30 for different wheel materials

Plates



Brake Option



Wheel Sizes

150mm x 50mm	250mm x 100mm
150mm x 75mm	300mm x 75mm
200mm x 75mm	300mm x 100mm
200mm x 100mm	400mm x 100mm
250mm x 75mm	

HTT SERIES

Super Heavy Duty Loads **500-2000 KGS.**

Suitable for heavy duty Industrial & Hospital equipments.



Refer page 15-30 for different wheel materials

Plates



Wheel Sizes

150mm x 75mm
200mm x 75mm
250mm x 75mm

ASBTT SERIES

Super Heavy Duty Loads **3000 KGS.**

Suitable for heavy duty Industrial trolleys & canteen equipments.



Refer page 15-30 for different wheel materials

Plates



Wheel Size

250mm x 100mm

WHEELS

KNOW MORE ABOUT OUR **WHEELS**



<p>CTN Cushion Tyred with Nylon Centre</p>  <p>Page no. 16</p>	<p>GTP Cushion Tyred with PP Centre</p>  <p>Page no. 16</p>	<p>CT Cushioned Tyred</p>  <p>Page no. 17</p>	<p>RGCT Cushion Tyred with Yellow Lines</p>  <p>Page no. 18</p>	<p>C Cast Iron</p>  <p>Page no. 19</p>	<p>R Rubber</p>  <p>Page no. 20</p>
<p>PT Fibre Tyred</p>  <p>Page no. 21</p>	<p>NT Nylon Tyred</p>  <p>Page no. 21</p>	<p>TPR Thermoplastic Rubber</p>  <p>Page no. 22</p>	<p>A High Density Alkathene</p>  <p>Page no. 23</p>	<p>RPU Polyurethane Tyred</p>  <p>Page no. 24</p>	<p>UHM Ultra High Molecular Weight</p>  <p>Page no. 25</p>
<p>P Fibre/Phenorex</p>  <p>Page no. 26</p>	<p>N Nylon</p>  <p>Page no. 27</p>	<p>NC Nylocast Wheel</p>  <p>Page no. 28</p>	<p>RT Rubber Tyred</p>  <p>Page no. 29</p>	<p>GTWH Cushion Tyred Semi Hollow</p>  <p>Page no. 30</p>	<p>CT 16 Cushion Tyred Traction</p>  <p>Page no. 30</p>



CTN

Cushion Tyred with Nylon Centre Wheels

Features

Black Rubber tyres are moulded onto Black Nylon centres under controlled temperature and pressure.

Bearings :





PB/NRB/BP/BB*

Temperature :

Intermittently upto 140° C

Finish :

Black Rubber and Black Nylon centres.

 Wheel Diameter(mm)	 Tread Width(mm)	 D Hole(mm)	 Type of Bearing	 KG
50	22	6	PLAIN	8
63	22	9	PLAIN	10
63	28	12	PLAIN	30
75	22	9	PLAIN	25
75	28	12	PLAIN	40
75	31	15*	PLAIN	45
80	40	9	CB	60
100	22	9	PLAIN	50
100	28	12	PLAIN	60
100	38	9	BP	75
100	40	9	CB	100
125	28	12	PLAIN	120
125	31	15*	PLAIN	135
125	38	15	PLAIN	150
125	50	19	PLAIN	170
150	25	16	CB	135
150	31	6	BP	140
150	50	19	PLAIN	150
160	40	19	PLAIN	160
200	25	16	CB	200
200	50	19	PLAIN	250

Ideal for :

Normal loads and kind to floors.

- Low Abrasion
- Maintenance free
- High temperature resistance





OPTIONS

Available with Grey Tyres and Black Nylon Centres (GCNW)

*Please enquire as per requirements & availability



DIMENSIONS FOR CTP*

 Wheel Diameter(mm)	 Tread Width(mm)	 D Hole(mm)	 Type of Bearing	 KG#
150	50	25	PB	125
175	50	25	PB	150
200	45	12	PB	160
200	50	25	PB	180
250	75	16	CB	225

Also available with PP centre CTP*





CT

Cushion Tyred Wheel

Features

The tyres for these wheels are moulded in Natural Rubber in Black colour under controlled temperature and pressure, mounted on to detachable Zinc Plated steel discs.

Bearings :

CB/SB/bb/GM/NRB/BB/BP*

Temperature :

Intermittently upto 140° C

Finish :





Black tyres and Zinc plated steel discs.

Ideal for :

Normal loads, hard wearing, and kind to floors.

- Low Abrasion
- Fracture resistant
- Maintenance free
- High temperature resistance

Antistatic or Conductive wheels available in all sizes. (ACT)

 Wheel Diameter(mm)	 Tread Width(mm)	 D Hole(mm)	 Type of Bearing	 KG
150	38	25	SB/RB/BB	125
150	50	25	SB/RB/BB	150
150	75	25	SB/RB/BB	200
200	50	25	SB/RB/BB	150
200	75	25	SB/RB/BB	250
250	31	16	CB	155
250	50	25	SB/RB/BB	175
250	75	25	SB/RB/BB	200
300	50	25	SB/RB/BB	175
300	88	25	SB/RB/BB	500
350	50	25	SB/RB/BB	350
400	38	19	RB	100

OPTIONS

Tyres also available in Grey colour (GCTW)

**Please enquire as per requirements & availability*





RGCT

Cushion Tyred Wheels with Yellow Lines

Features

The tyres for these wheels are moulded in Natural Rubber in Black colour under controlled temperature and pressure having Yellow painted lines and mounted on to detachable Zinc plated steel discs.

Bearings :

SB/bb/GM/NRB/BB/BP*

Temperature :

Intermittently upto 140° C

Finish :





Black tyres and Zinc plated steel discs.**

Ideal for :

Normal loads, hard wearing, and kind to floors.

- Low Abrasion
- Fracture resistant
- Maintenance free
- High temperature resistance

Antistatic or Conductive wheels available in all sizes. (RGCT/ANS)

 Wheel Diameter(mm)	 Tread Width(mm)	 D Hole(mm)	 Type of Bearing	 KG
75	29	12	ROLLER	50
100	29	15	ROLLER	70
125	37	15	ROLLER	100
160	40	19	ROLLER	135
180	50	19	ROLLER	170
200	50	19	ROLLER	205
250	50	25	ROLLER	290
250	60	25	ROLLER	310
280	50	25	ROLLER	250
280	63	25	ROLLER	350
300	50	25	ROLLER	275
300	75	25	ROLLER	375
325	75	25	ROLLER	400
350	75	25	ROLLER	400
325	100	25	ROLLER	500
400	63	25	ROLLER	300
400	100	25	ROLLER	500

OPTIONS

Tyres also available in Grey colour **CTRG/Grey**

*Please enquire as per requirements & availability

**Powder coating on steel discs



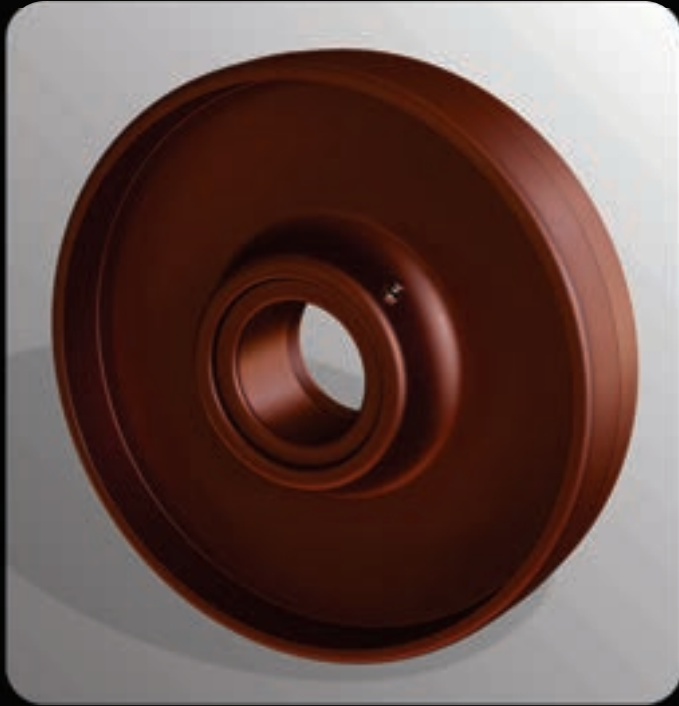

C

Cast Iron Wheels

Features

Cast iron wheels are resistant to high temperatures with low rolling resistance. Recommended for medium loads. Also used in high temperature furnaces. Not suitable in the presence of strong acids or chlorinated solvents.

Bearings :

PB/SB/bb/GM/NRB/MRB/BB/TRB*

Temperature :

From -7° C to + 82° C

Finish :

Standard Red Oxide spray painted**

Ideal for :

Cast Iron wheels, are suitable for use of over greasy or oily surface where rubber wheels may prove unsuitable, where floor protection is not a factor.





- High load capacity
- Abrasion resistant
- Maintenance free
- Resistant against metal cuttings
- Resistant against oil
- High temperature resistance

OPTIONS

- High temperature Grease also available.
- V Grooved and Flanged wheel for use on rail or inverted angle Iron tracks **S1/ S2/ S3** are also available.

*Please enquire as per requirements & availability

**Also available in Powder coating and grey Paint

 Wheel Diameter(mm)	 Tread Width(mm)	 D Hole(mm)	 Type of Bearing	 KG
50	22	6	PLAIN	70
63	22	9	PLAIN	100
63	28	12	PLAIN	110
75	22	9	PLAIN	135
75	28	12	PLAIN	160
75	31	15	PLAIN	180
75	38	16	PLAIN	190
100	22	9	PLAIN	200
100	28	12	PLAIN	210
100	31	15	PLAIN	220
100	38	19	PLAIN	240
100	50	25	PLAIN	300
125	31	15	PLAIN	250
125	38	19	PLAIN	290
125	50	25	PLAIN	600
150	38	19	PLAIN	900
150	50	25	PLAIN	950
200	50	25	PLAIN	700
200	75	25	PLAIN	2200
250	50	25	PLAIN	1200
250	75	25	PLAIN	2000
300	50	25	PLAIN	1300
300	75	25	PLAIN	1500





R

Rubber Wheels

Features

Wheels moulded out of Rubber by vulcanisation of specially formulated Natural substances. The mix is intended to provide good sliding, good resistance to wear and high elasticity.

Wheels are moulded around Nylon bushes and Metal bushes with Black Natural Rubber under controlled temperature and pressure.

Bearings :

NB/SB/MS/bb*

Temperature :

Normal Room Temperatures

Finish :

Black

Ideal for :

Rubber wheels may be used for many light duty applications having resistant to occasional mild chemical contacts.

- Good load capacity
- Good resistant to wear
- Very low rolling resistance
- Excellent operational comfort
- Floor saving
- Maintenance free

OPTIONS

Wheels also available in Hard Rubber (Ebonite)

Wheels also available in Grey Rubber (RWG)

Conductive/Antistatic Rubber available (RW/ANS)

**Please enquire as per requirements & availability*



Wheel Diameter(mm)	Tread Width(mm)	D Hole(mm)	Type of Bearing	KG
25	-	4	PLAIN	6
38	22	6	PLAIN	9
50	22	6	PLAIN	25
63	22	9	PLAIN	30
63	25	8	PLAIN	35
63	28	12	PLAIN	50
75	22	9	PLAIN	15
75	28	12	PLAIN	50
75	31	15	PLAIN	60
75	38	16	PLAIN	75
100	22	9	PLAIN	60
100	25	8	PLAIN	50
100	28	12	PLAIN	60
100	31	15	PLAIN	70
100	38	19	PLAIN	100
100	50	19	PLAIN	130
125	31	19	PLAIN	140
125	38	19	PLAIN	150
150	38	19	PLAIN	140
150	45	25	PLAIN	160
150	50	25	PLAIN	180



PT

Fibre Tyred Wheels

Features

These wheels are moulded in macerated canvas cloth amalgamated with Phenolic resin under controlled temperature and pressure mounted on to Cast Iron centres providing a single solid unit.

Bearings :

PB/SB/bb/GM/NRB/MRB/BB/TRB*

Temperature :

Intermittently upto 149° C**

Finish :

Brown fibre and Red cast iron centres.

Ideal for :

High static loads, hard wearing, and kind to floors.

- Low Abrasion
- Maintenance free
- High temperature resistance

Wheel Diameter(mm)	Tread Width(mm)	D Hole(mm)	Type of Bearing	KG	KG#
50	22	6	PLAIN	40	-
63	22	9	PLAIN	40	-
63	28	12	PLAIN	130	-
75	22	9	PLAIN	60	-
75	28	12	PLAIN	130	-
75	31	15	PLAIN	130	-
75	38	16	PLAIN	180	-
75	50	12	BEARINGS	-	200
100	22	9	PLAIN	60	-
100	28	12	PLAIN	130	-
100	31	15	PLAIN	225	200
100	38	19	PLAIN	250	220
100	50	25	PLAIN	275	250
125	31	15	PLAIN	240	-
125	38	15	PLAIN	260	240
125	50	25	PLAIN	375	280
150	38	19	PLAIN	400	300
150	50	25	PLAIN	575	450
150	75	25	PLAIN	700	550
200	50	25	PLAIN	750	650
200	75	25	PLAIN	1075	850
250	56	25	PLAIN	875	-
250	75	25	BEARINGS	1200	-
250	100	25	BEARINGS	1500	-
300	50	25	BEARINGS	1500	-
300	75	25	BEARINGS	200	-

All loads bearing capacity mentioned for **Static** loads



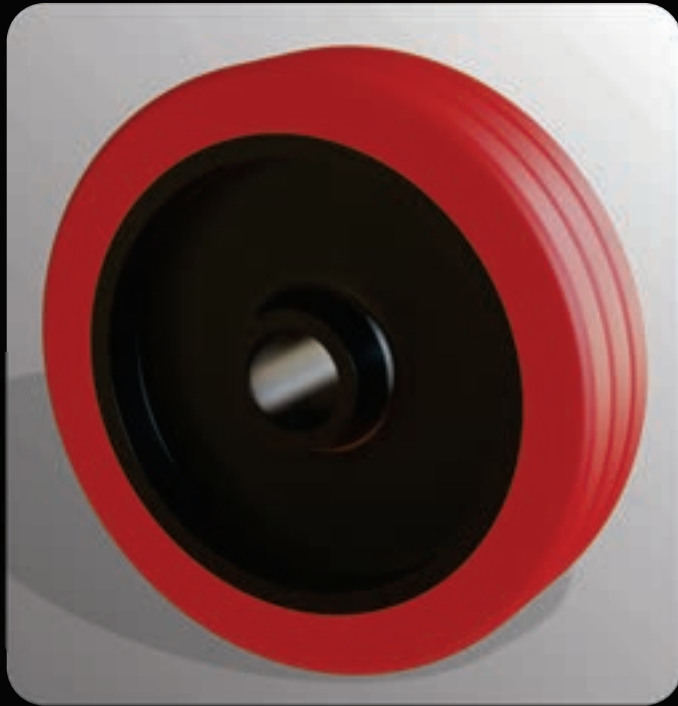

TPR

Thermoplastic Rubber on PP centre

Features

High - quality thermoplastic rubber, non-marking, chemically-bonded with wheel centre.

Wheel centre:

High - quality polypropylene(pp)

Bearings :

PB/NRB/BB/BP*

Temperature :

From -30°C upto +60°C under normal conditions





Ideal for :

- High static load capacity
- Low Abrasion
- Fracture resistant
- High chemical resistance against alcohol, salt, grease and acids
- Maintenance free

OPTIONS

*Available colour combinations



 Wheel Diameter(mm)	 Tread Width(mm)	 D Hole(mm)	 Type of Bearing	 KG
38	22	6	PLAIN	30
50	22	6	PLAIN	40
63	22	9	PLAIN	45
63	28	12	PLAIN	50
75	22	9	PLAIN	60
75	28	12	PLAIN	70
75	31	15	PLAIN	80
75	38	16	PLAIN	100
100	25	25	PLAIN	100
100	28	12	PLAIN	120
100	31	15	PLAIN	135
100	38	19	PLAIN	150
100	50	19	PLAIN	160
125	31	15	PLAIN	150
125	38	19	PLAIN	180
125	50	19	PLAIN	225
150	38	19	PLAIN	330
150	50	19	PLAIN	375
200	50	19	PLAIN	450
150	25	25	PLAIN	375
200	25	25	PLAIN	450



A

High Density Alkathene Wheels

Features

Product made out of alkathene is obtained by using injection moulding technique under controlled temperature and pressure.

Alkathene offers good sliding, good mechanical properties, excellent resistance to blow, high dimensional stability and durability.

Reaction to aggressive chemicals is optimal.

Bearings :

PB/NRB/BP/BB*

Temperature :

Normal Room Temperatures

Finish :

Natural White Colour

Ideal for :

These wheels may be used instead of Nylon on good floor surfaces where light loads are to be carried at normal room temperature. Having good chemical resistance, low water absorption and offers non marking floor protection, light in weight having resistance to most oils, chemicals, grease.

- Medium load capacity
- Abrasion resistant
- Maintenance free
- Resistant against oil
- High temperature resistance

OPTIONS

**Please enquire as per requirements & availability*



 Wheel Diameter(mm)	 Tread Width(mm)	 D Hole(mm)	 Type of Bearing	 KG
25	0	0	PLAIN	5
38	22	6	PLAIN	10
50	22	6	PLAIN	30
63	22	9	PLAIN	45
63	28	12	PLAIN	60
75	22	9	PLAIN	60
75	28	12	PLAIN	70
75	31	15	PLAIN	75
75	38	15/19	PLAIN	80
100	22	9	PLAIN	65
100	28	12	PLAIN	100
100	31	15	PLAIN	120
100	38	19	PLAIN	150
100	50	19/25	PLAIN	175
125	31	15	PLAIN	140
125	38	19	PLAIN	160
150	38	19	PLAIN	200



RPU

Polyurethane Tyred Wheels

Features

Polyurethane is an elastomer with a high breaking point and a high co-efficient of elasticity; it offers excellent elasticity and hardness and high resistance to compression, bending and abrasion for high strength, high static loads, hard wearing, and upto 10 times the life of natural rubber under similar conditions and load. With load capacity upto 3 times that of equivalent rubber wheel. Resistance to ageing, mineral oils and greases, solvents and diluted alcohol and bases.

Bearings :

PB/SB/bb/GM/NRB/MRB/BB/TRB*

Temperature :

From -30°C upto $+80^{\circ}\text{C}$ under normal conditions

Finish :

Red Polyurethane and Red cast iron centres.





Ideal for :

- High load capacity
- High tear resistant
- Robust and Abrasion resistant
- Floor saving
- Shock and vibration damping
- Resistant against several acids
- Resistant against oil, petrol and most chemicals

OPTIONS

*Please enquire as per requirements & availability



 Wheel Diameter(mm)	 Tread Width(mm)	 D Hole(mm)	 Type of Bearing	 KG
50	22	6	PLAINS	70
63	22	9	PLAINS	100
63	28	12	PLAINS	115
75	22	9	PLAINS	90
75	28	12	PLAINS	125
75	31	15	PLAINS	150
75	38	16	PLAINS	180
100	22	9	PLAINS	110
100	28	12	PLAINS	200
100	31	15	PLAINS	225
100	38	19	PLAINS	240
100	50	25	PLAINS	275
125	31	15	PLAINS	250
125	38	19	PLAINS	300
125	50	25	PLAINS	350
150	38	19	PLAINS	450
150	50	25	PLAINS	600
150	75	25	PLAINS	750
200	50	25	PLAINS	1000
200	75	25	PLAINS	1400
250	56	25	PLAINS	1400
250	75	25	BEARINGS	2000
250	100	25	BEARINGS	2500
300	50	25	BEARINGS	1100
300	75	25	BEARINGS	2000
300	88	30	BEARINGS	2500
300	100	30	BEARINGS	3000
300	125	30	BEARINGS	3500
350	75	30	BEARINGS	4000
400	75	30	BEARINGS	3000
400	100	30	BEARINGS	2000
525	150	50	BEARINGS	5000

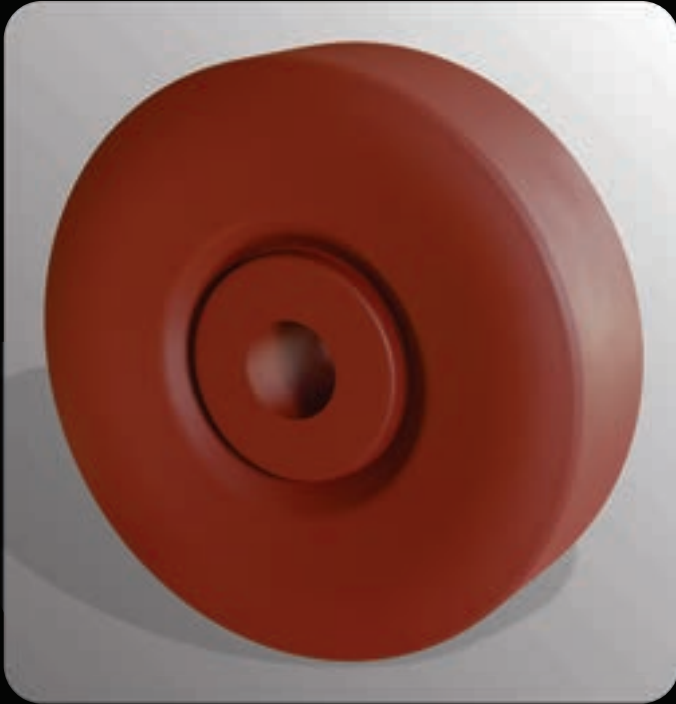

UHM

Ultra High Molecular Weight Wheels

Features

Crown tread wheels are moulded under controlled temperature and pressure in accurately formed close fitting moulds for unique strength and toughness.

Bearings :

PB/NRB/BB*

Temperature :

-240°C to +100° C

Finish :

Red Colour

Ideal for :

Wheels are light in weight, clean and able to be used with the minimum of lubrication. They are virtually non marking and are resistance , low water absorption and offers non marking floor protection, may be used for light and medium duty applications.





- High waer resistant and impact strength
- High load capacity
- Abrasion & Corrosion resistant
- Maintenance free
- Resistant against metal cuttings
- Resistant against oil, chemicals, acids

OPTIONS

Natural White colour wheels available.

**Please enquire as per requirements & availability*



 Wheel Diameter(mm)	 Tread Width(mm)	 D Hole(mm)	 Type of Bearing	 KG
38	22	6	PLAINS	35
50	22	6	PLAINS	50
63	22	10	PLAINS	75
63	28	12	PLAINS	100
75	22	10	PLAINS	100
75	28	12	PLAINS	100
75	31	15	PLAINS	115
75	38	15	PLAINS	125
100	22	10	PLAINS	100
100	28	12	PLAINS	140
100	31	15	PLAINS	165
100	38	19	PLAINS	200
100	50	19	PLAINS	250
125	28	12	PLAINS	135
125	38	19	PLAINS	250
125	50	25	PLAINS	350
150	38	25	PLAINS	350
150	50	25	PLAINS	500
150	75	25	PLAINS	800
200	50	25	PLAINS	1000
200	75	25	PLAINS	1250
250	50	25	PLAINS	1150
250	75	25	PLAINS	1450
300	50	25	PLAINS	1200
300	75	25	PLAINS	1550

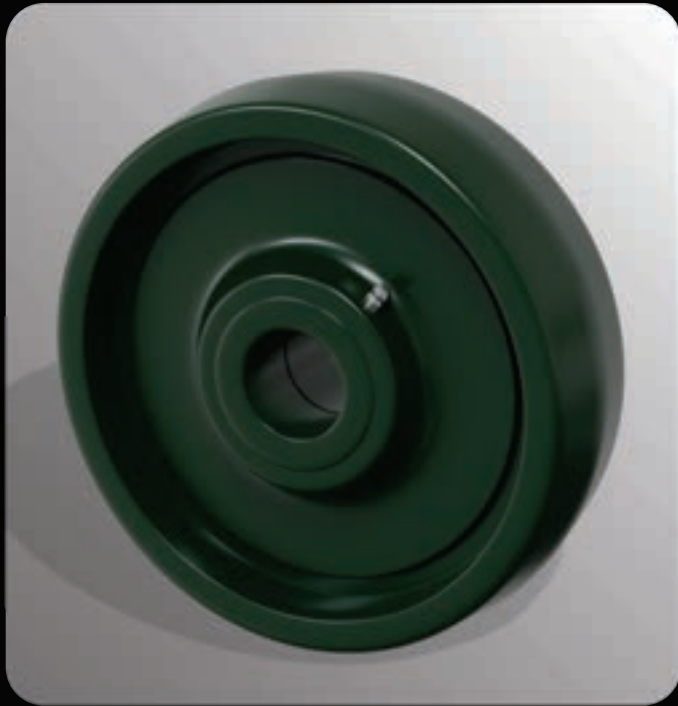

P

Fibre/Phenorex Wheels

Features

Fibre/Phenorex Wheels are moulded in macerated canvas cloth amalgamated with phenolic resin, increasing rigidity as temperature rises. They are manufactured using the compression technique with controlled temperature and pressure.

Bearings :

PB/SB/bb/GM/NRB/MRB/BP/BB/TRB*

Temperature :

Intermittently ranging from -20°C to +160° C

Finish :

Standard colour is Brown and Green

Ideal for :

Textile Mills, Bakeries, Chemical plants, Cold Storages etc, for static loads, hard wearing and kind to floors.





- High static load capacity
- Low Abrasion
- Fracture resistant
- High chemical resistance against alcohol, salt, grease and acids
- Maintenance free
- High temperature resistance

OPTIONS

- High temperature Grease also available.

**Please enquire as per requirements & availability*



 Wheel Diameter(mm)	 Tread Width(mm)	 D Hole(mm)	 Type of Bearing	 KG
38	22	6	PLAINS	30
50	22	6	PLAINS	35
63	22	9	PLAINS	35
63	28	12	PLAINS	100
75	22	9	PLAINS	60
75	28	12	PLAINS	110
75	31	15	PLAINS	125
75	38	15	PLAINS	160
100	22	9	PLAINS	60
100	28	12	PLAINS	120
100	31	15	PLAINS	180
100	38	19	PLAINS	210
100	50	25	PLAINS	240
125	28	12	PLAINS	120
125	38	19	PLAINS	230
125	50	25	PLAINS	275
150	38	19	PLAINS	330
150	50	25	PLAINS	460
150	75	25	PLAINS	620
200	50	25	PLAINS	630
200	75	25	PLAINS	850
250	50	25	PLAINS	750
250	75	25	PLAINS	1000
300	50	25	PLAINS	950
300	75	25	PLAINS	1300



N

Nylon Wheels

Features

Product made of polyamide, normally referred to as Nylon, are injection moulded Thermoplastic. Nylon has a low friction co-efficient which ensures good sliding. It has a high breaking point and low wear, which makes for a long-lasting product which is insensitive to chemical and atmospheric agents. Its low specific weight also makes Nylon products light weight. It also does not require special disposal at the end of its useful lifespan and is easily recycled.

Bearings :
PB/NRB/BP/BB*

Temperature :
-45°C to +180° C

Finish :
Natural White colour

Ideal for :

Nylon wheels are virtually non marking, cause very little floor damage and are resistant to oils, fats. Having good chemical resistance, low water absorption and offers non marking floor protection, may be used for light and medium duty application.

- High load capacity
- Abrasion resistant
- Maintenance free
- Resistant against metal cuttings
- Resistant against oil
- High temperature resistance

OPTIONS

Grey and Red colour wheels available.

*Please enquire as per requirements & availability

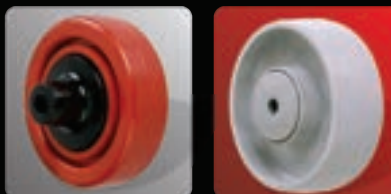

Wheel Diameter(mm)	Tread Width(mm)	D Hole(mm)	Type of Bearing	KG
25	-	3	PLAIN	10
38	22	6	PLAIN	15
50	22	6	PLAIN	40
63	22	9	PLAIN	60
63	28	12	PLAIN	80
75	22	9	PLAIN	60
75	22	BP/NTG	BP	100
75	28	12	PLAIN	80
75	31	12	PLAIN	80
75	31	BP/NTG	BP	120
75	38	16	PLAIN	120
75	38	15	ROLLER	150
100	22	9	PLAIN	70
100	22	BP/NTG	BP	210
100	28	12	PLAIN	120
100	31	15	PLAIN	135
100	31	15	ROLLER	175
100	38	19	PLAIN	200
100	38	15	ROLLER	225
100	38	15	BEARINGS	250
100	50	19	PLAIN	225
100	50	17	BB	250
100	50	19	ROLLER	275
125	31	15	PLAIN	225
125	38	15	PLAIN	140
125	38	19	ROLLER	250
125	38	17	BEARINGS	300
150	38	19	PLAIN	300
150	38	19	ROLLER	350
150	38	17	BEARINGS	400
150	45	19	PLAIN	400
150	45	19	ROLLER	450
150	45	17	BEARING	500
150	50	19	PLAIN	450
150	50	19	ROLLER	500
150	50	17	BEARINGS	550
200	45	19	PLAIN	400
200	45	19	ROLLER	450
200	45	17	BEARINGS	550
200	50	19	PLAIN	500
200	50	19	ROLLER	520
200	50	17	BEARINGS	550



NC

Nylocast Wheel

Features

These wheels are moulded in hard and tough, highly compressed cast nylon & are the ultimate choice for extremely high loads where metallic wheels are not an option. These wheels possess very high abrasion resistance and offer low rolling resistance under extreme loads.

Bearings :





PB/BB/TRB

Temperature :

-30°C to +80° C.

Ideal for :

- High load capacity
- Maintenance free
- High chemical resistance

 Wheel Diameter(mm)	 Tread Width(mm)	 D Hole(mm)	 Type of Bearing	 KG
80	40	20	Bearings	700
100	40	20	Bearings	900
100	50	25	Bearings	1100
125	50	25	Bearings	1400
150	50	30	Bearings	1800
150	75	35	Bearings	2100
200	50	35	Bearings	2100
200	75	45	Bearings	3200
250	65	45	Bearings	3500
250	75	50	Bearings	4200
300	75	55	Bearings	5000
300	100	70	Bearings	7000
400	100	80	Bearings	8500



RT

Rubber Tyred Wheels

Features

These wheels are moulded on to Cast Iron centres with Black Natural Rubber under controlled temperature and pressure providing a single solid unit.

Bearings :

PB/SB/bb/GM/NRB/MRB/BB/TRB*

Temperature :

Intermittently upto 140°C

Finish :

Black Rubber and Red Cast Iron centres.

Ideal for :

They can be used safely on any type of flooring without risk of damage to the surface and move smoothly and silently even under heaviest of loads, hard wearing, and kind to floors.

- High static load capacity
- Low Abrasion
- Fracture resistant
- Maintenance free
- High temperature resistance

OPTIONS

Available with Grey Tyres (RTWG) & Special application Rubber





*Please enquire as per requirements & availability



Wheel Diameter(mm)	Tread Width(mm)	D Hole(mm)	Type of Bearing	KG
50	22	6	PLAIN	40
63	22	9	PLAIN	70
63	28	12	PLAIN	80
75	22	9	PLAIN	70
75	28	12	PLAIN	75
75	31	12-16	PLAIN	80
75	38	16	PLAIN	100
100	22	9	PLAIN	40
100	28	12	PLAIN	100
100	31	16	PLAIN	110
100	38	19	PLAIN	140
100	50	19	PLAIN	160
125	31	19	PLAIN	140
125	38	19	PLAIN	150
125	50	19	PLAIN	170
150	38	19	PLAIN	340
150	50	25	PLAIN	360
150	75	*	PLAIN	400
200	50	25	PLAIN	500
200	75	25	PLAIN	550
250	56	25	PLAIN	600
250	75	25	BEARINGS	900
250	100	25	BEARINGS	1000
300	50	25	BEARINGS	650
300	75	25	BEARINGS	1000
300	88	25	BEARINGS	1200
300	100	*	BEARINGS	1300
300	125	25	BEARINGS	1500
350	75	25	BEARINGS	1300
400	75	25	BEARINGS	1500
400	100	25	BEARINGS	1650
525	150	25	BEARINGS	3000



CTWH

				
Wheel Diameter(mm)	Tread Width(mm)	D Hole(mm)	Type of Bearing	KG
325	63	16	CB	200

CTWH/CT 16

Cushion Tyred Semi-Hollow Wheels

Cushion Tyred Traction Wheels

Features

The tyre for these wheels are moulded in Natural Rubber in Black colour under controlled temperature and pressure mounted on to detachable steel discs.

Bearings :

CTWH - SB/bb/GM/NRB/BB/BP*

CT 16 - BB/TRB*

Temperature :

Intermittently upto 140°C



Finish :

CTWH - Black tyre and Green Powder coated Steel discs.

CT 16 - Black tyres and Grey spray painted steel discs.**



CT 16

				
Wheel Diameter(mm)	Tread Width(mm)	D Hole(mm)	Type of Bearing	KG
400	100	25*	BEARINGS	1000
400	100	25*	BEARINGS	1000
400	125	25*	BEARINGS	1400

Ideal for :

Hard wearing, and kind to floors. There is no valve system to leak or puncture. The tyre construction of Resilient Rubber gives a pneumatic bounce with solid strength.

- High static load capacity
- Low Abrasion
- Fracture resistant
- Maintenance free
- Medium temperature resistance

OPTIONS

CTWH - Tyres available in Grey colour (GCTW)

CT 16 - Pressed steel discs are press fitted on the tyres Reinforcement by steel wires and cord fabric in the tyre Also available in star type forged hub

*Please enquire as per requirements & availability

**Powder coating on steel discs



CT16/400/100/B5/SOFT

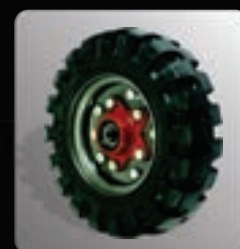

CT16/400/100/B5/TUFI

PLAT/F/7146/TRLY

DIMENSION: 710mm. x 460mm.

PARTICULARS: 18 gauges pressed steel formed deck reinforced with pressed steel formed running beams and cross beams.

BUFFERS: "DASH" rubber corner buffers with platform protection matting

HANDLE: Tubular reinforced with pressed steel back/can be folded flat.

CASTORS: 2 swivels + 2 fixed 100mm. dia, rubber on nylon centers.

CAPACITY: Load capacity 150 kg.

FINISH: Powder coated oven baked epoxy "SIEMENS GREY".

PACKING: Heavy duty branded corrugated carton.



150 KG

PLAT/F/9060/TRLY

DIMENSION: 900mm. x 600mm.

PARTICULARS: 16 gauges pressed steel formed deck reinforced with heavy duty formed 16 gauge running and crossed beams.

BUFFERS: "DASH" rubber corner buffers.

HANDLE: Heavy duty tubular reinforced with pressed steel back, 340mm. above deck – supplied loose with heavy 22mm. nuts and special flat spring washers for easy assembly/handle can be folded flat in PLAT-F-9060.

CASTORS: 2 swivels + 2 fixed matching rigid, pressed steel heavy duty castors 130mm. dia, with integrally moulded on heavy duty pressed steel centers with ball bearing, with thread guards.

CAPACITY: Load capacity 350 kgs.

FINISH: Powder coated oven baked epoxy "SIEMENS GREY".

PACKING: Heavy duty branded corrugated carton.



350 KG

PLATFORM TROLLIES



OTHER TROLLIES

SNGL/GAS/CYL200/R

 65



DBL/GAS/CYL300/R

 80



HESS/NINE/250

 200



SACK/FLDGNOS/200

 100



SWB/GT/325/75/R

 60



DWB/GT/350/50/R

 150



DRUM STD

 205



**SACK/2INI/GTP/250/75
/CB/TRLY**

 150



SACK/DY/9000



SACK/84



**MFT/3BIN/15L/SMAL/
TRLY**

 150



OTHER PRODUCTS

FOOTLOCK



DOOR RUNNER



COOK RIDER



CONVEYOR ROLLER



BALL TRANSFER UNIT



FRIDGE CASTOR



GATE CASTOR



DOOR TRACKS



DOOR WHEEL



GBLL



GLIDE WHEEL



HDA BUFFERS



RUBBER CHOKE

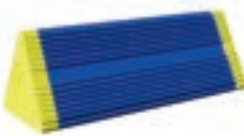

RUBBER CORNER BUFFERS



TURN TABLE



GLASS CASTOR



CORNER CASTOR



SYMBOLS FOR CASTORS

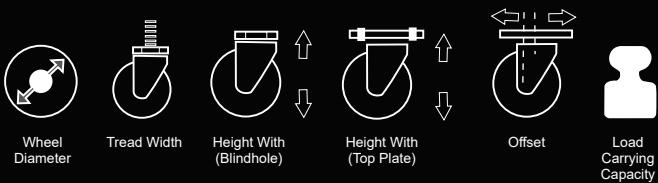

PRODUCT CODE FOR CASTORS

RD3/PT/WHM/125

RD3 - Product family as per load carrying capacity and its use
 PT - Top fixture for castor 'PT' for swivel & 'F' for Fixed
 WHM - Wheel Material - rubber, nylon, cast iron, etc.
 125 - Wheel Diameter

PRODUCT CODE FOR WHEEL

R 25 x 13 - O 4
 R 25 - Wheel Material
 25x13 - Wheel Diameter x Wheel Breadth
 4 - D-Hole

SYMBOLS FOR WHEELS

